

Ucard 2

Card Reader



In order to guarantee a better experience when using, please read the manual carefully before operating the device.

Contents

Device Appearance	2
Package List	3
Mounting Diagram & Step	4
Wiring Instructions	5
Operation Instructions	6
System architecture diagram	7

Device Appearance

Dimension Unit: mm

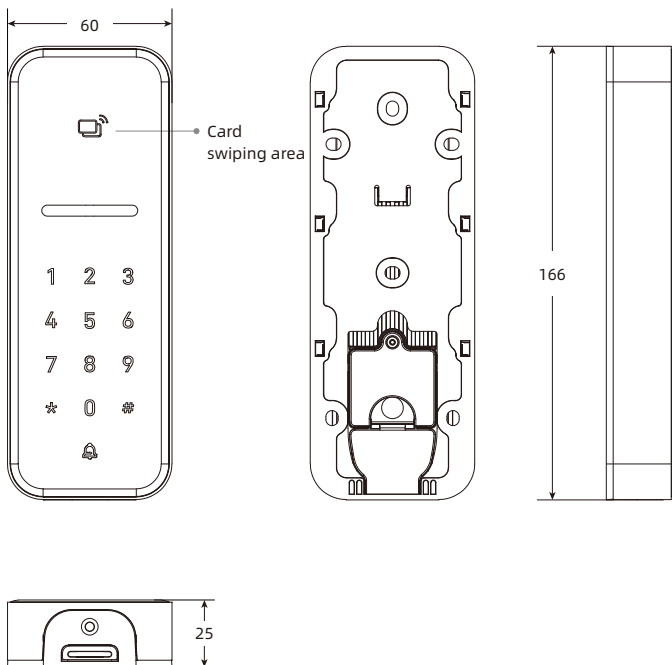

Package List

- 1 Host
- 2 Manual
- 3 Self-tapping Screw
- 4 Wall Mounting
- 5 Wrench
- 6 Anti-tamper screws

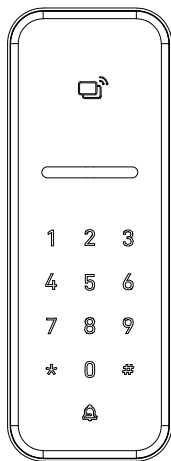

1

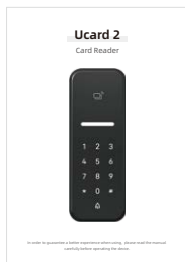

2



3

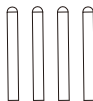

4



5



6

Mounting Diagram & Step

- 1 For wall-mounted installation, select the appropriate hole position according to the hole position of the installation sticker, and bury the expansion

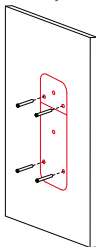

- 2 Use self-tapping screws to fix the bracket to the wall; (If external wiring is used, first remove the horizontal bar at the bottom of the bracket with pliers, take out the connection wires on the back of the device, and pass them through the bottom hole of the bracket in advance)

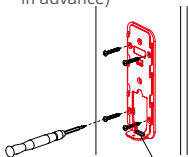

When wiring externally, remove the connecting wire passing through here

- 3 Connect the cables on the back of the device according to the wiring instructions; (If necessary, you can open the back cover of the device, unplug the device cables and connect them, then connect the cables to the device and cover the back cover)



Rear cover fixing screws

- 4 Align the card slot on the back of the device with the bracket buckle and insert the device downward into place;

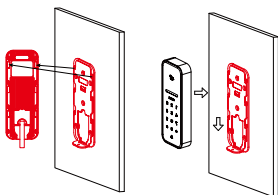

- 5 Press the device and tighten the anti-tamper screws with a wrench to complete the installation.

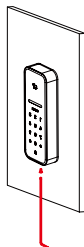

Wiring Instructions



RED — 12V
BLACK — GND

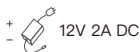

WHITE — WD0
YELLOW — WD1
BLACK — GND

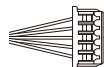

YELLOW — BUTTON
BLUE — SENSOR
BLACK — GND
ORANGE — RS485+
BROWN — RS485-

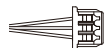
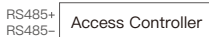

WHITE — INWD0
GREY — INWD1
BLACK — GND

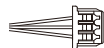

WHITE — NO
ORANGE — COM
RED — NC



Normally Open or Normally Closed
can be connected according to the
actual situation.

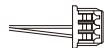

WHITE — ALARM
BLACK — GND



BLUE — BUELL=OUT
BLACK — GND



Operation Instructions

Device Activation

After the first power-on, the white indicator light on the device will flash quickly. This means the device is not activated and needs to be activated. There are two ways to set it up:

1. Activate the device password. For details, see the device operation method.
2. Log in to 192.168.0.88:8090 and follow the steps to activate the device. The equipment stand-alone operation function list is as follows:

Key: * **Clear/Back**

can clear the key input or return to the previous menu

Key: # **Enter the operation menu**

and only after entering the operation menu can you select and enter each function item

Key: 0# **Set device password.**

If a password already exists, you need to verify the original device password first. If it does not exist, just enter a new password.

Key: 1# **Add user**

to add a single user, support adding employee number, card number, password

Key: 2# **Delete user**

to delete a single user. It supports deleting the entire user by employee ID or card number.

Key: 3# **Set the relay door opening time.**

If the device is not activated, this operation is not allowed. After verifying the device password, you can enter a number between 0-1440s to set it, press # to confirm, the default is 3s

Key: 4# **Set the door opening mode.**

If the device is not activated, this operation is not allowed. By default, the relay is executed after successful identification.

Key: 9# **Restore factory settings**

If the device is not activated, this operation is not allowed. After verifying the device password, the device automatically restores to factory settings.

• Enter the operation menu

Enter # to enter the administrator verification state, enter the 6-digit device password and press # to confirm. After successful verification, enter the menu interface. In the activated state, it will directly enter the menu interface.

- **Set a device password**

Step 1: On the menu interface, enter 0# to enter the device password setting menu.

Step 2: Enter a new 6-digit password and press # to confirm.

Step 3: Enter the 6-digit password again and press # to confirm.

If the two passwords are the same, the green light on the device will indicate that the setting is successful. If the red light is on, it means that the setting failed. You need to [set up the device again password] .

- **Adding Users**

Step 1: In the menu interface, enter 1# to enter the add user menu.

Step 2: Enter the user ID and press # to confirm.

Step 3: After confirmation, swipe the user card directly. If not required, press # to skip.

Step 4: Enter a 6-digit user password and press # to confirm. If not required, press # to skip.

After successful input, the green light on the device will turn on. If the red light on the device turns on, it means that the setting has failed and you need to [Add User] again.

- **Deleting a User**

Step 1: In the menu interface, enter 2# to enter the delete user menu.

Step 2: Enter the user password or swipe the user card and press # to confirm.

If the deletion is successful, the green light on the device will be on. If the red light on the device is on, it means that the deletion failed and you need to [Delete User] again.

- **Set door opening time**

Step 1: In the menu interface, enter 3# to enter the menu for setting the door opening time

Step 2: Enter the door opening time you want to set, such as 5s, enter 5, and press # to confirm.

If the setting is successful, the green light of the device will be on. If the red light of the device is on, it means that the setting has failed and you need to [Set the Door Opening Time] again.

- **Set door opening mode**

Step 1: In the menu interface, enter 4# to enter the door opening mode setting menu

Step 2: If you want to limit the relay output, set input 1 and press # to confirm; if you need the relay output, set input 0 and press # to confirm .

If the setting is successful, the green light of the device will be on. If the red light of the device is on, it means that the setting has failed and you need to [Set the door opening mode] again.

- **Restore factory settings**

Step 1: In the menu interface, enter 9# to enter the factory reset

Step 2: Enter the 6-digit device password and press # to confirm. The device automatically restarts and restores to factory settings.

- **forget the password**

Step 1: Restart the device and input 999# within 30 seconds after the device beeps to indicate that the power-on is complete. The device will then be restored to the temporary password 888888.

Step 2: Use a temporary password to reset the device password to ensure security.

- **Forgot password? Restore factory settings**

Power on and off the device again, and enter 000# within 30 seconds after the device beeps to indicate that the power-on is complete. The device will automatically restart and restore to factory settings. set up.

Batch personnel management



To add personnel in batches enter #+administrator password and press # to confirm, then enter 1 and press # to confirm to enter the personnel adding process. You can directly swipe the card to add personnel, and this process needs to be completed within 10 seconds.



To delete personnel in batches enter #+administrator password and press # to confirm, then enter 2 and press # to confirm. You can directly delete personnel cards by swiping them. This process needs to be completed within 10 seconds.

Identification



Swipe the card at the device to verify.

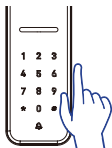

Enter your work number and password and press # to confirm.

Platform Usage

Login 192.168.0.88:8090



Ustar-Cloud



http://192.168.0.88:8090

System architecture diagram

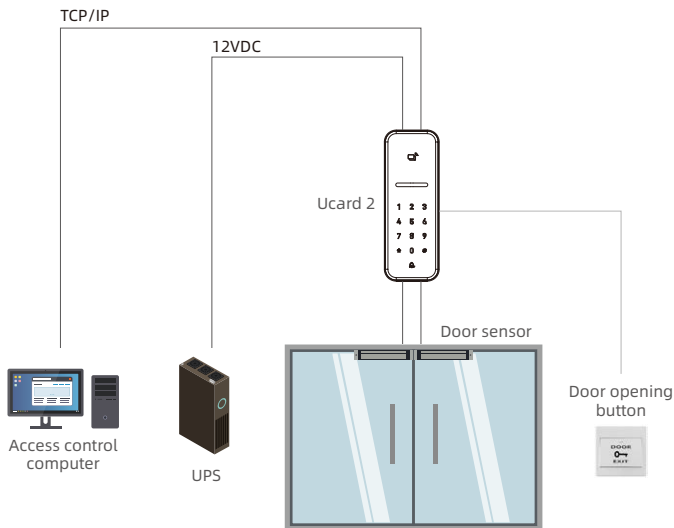



iOS



Android

Download an APP for more functions