

Installation Diagram

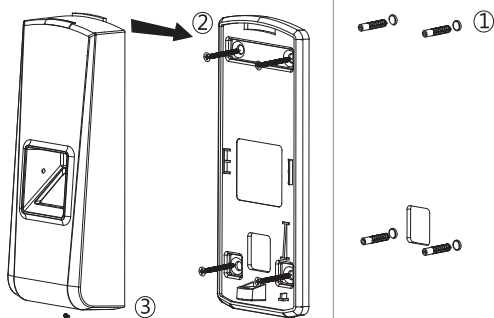

Installation Steps:

- ① Drill holes in the wall following the hole positions on back panel
- ② Install and fix the back panel, connect related cables
- ③ Fix access control reader

Wiring Instruction

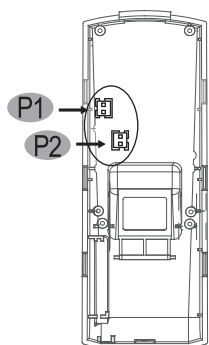

P1

Function	PIN	Description
Power	1	DC12V
	2	GND

P2

Function	PIN	Description
RS485	1	RS485A
	2	RS485B



T5S is an extended fingerprint sensor for Anviz access controller. It does not store any fingerprint template or match the fingerprint but just sent the fingerprint template to access controller via the RS485 to become a distributed access control system.



T5S works with T5Pro, T50/T50M, VF/VP30 and T60 access controller. And one access controller can just connect only one T5S.

T5S connects with T5Pro

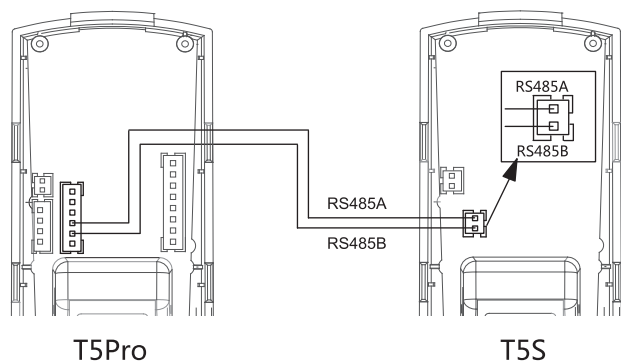

T5S connects with T50/T50M

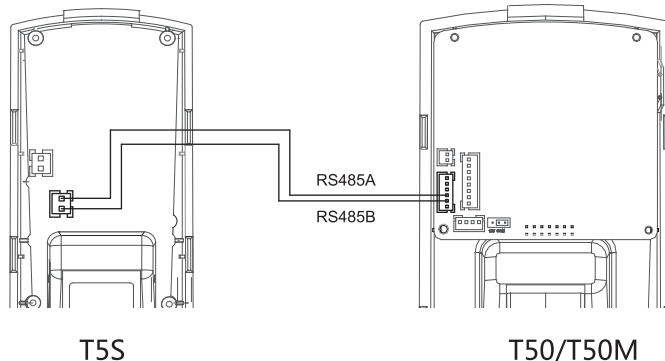

T5S connects with VF/VP30

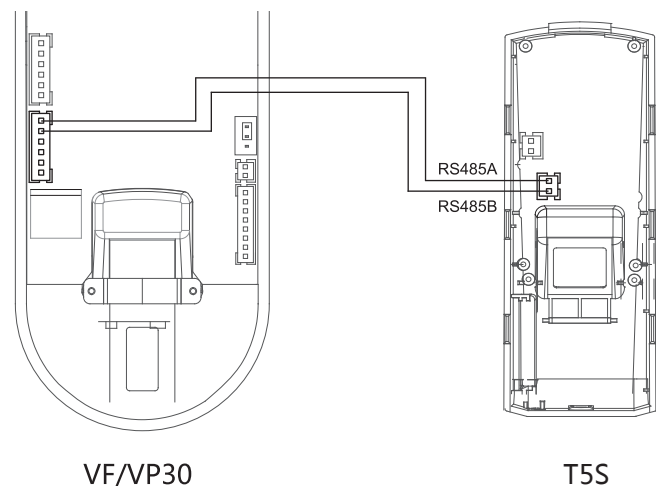

T5S connects with T60

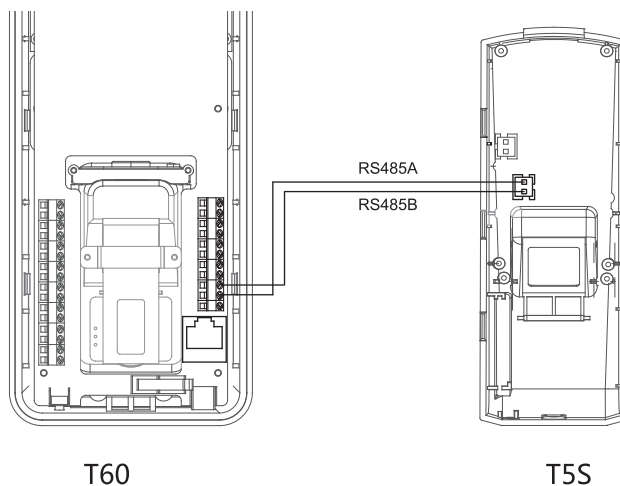

Notice: Please carefully check the access controller wiring diagram before connection. Any damaged products due to improper wiring are not covered under the product warranty.